



**CMI 2016
NEW YORK**
MAY 3 – 6, 2016



**COMITÉ MARITIME INTERNATIONAL / MARITIME LAW ASSOCIATION OF THE UNITED STATES
42ND INTERNATIONAL CONFERENCE OF THE CMI**

**WITH COMBINED MEETINGS OF CMI INTERNATIONAL WORKING GROUPS
AND MLA US COMMITTEES**

NEW YORK 3 – 6 MAY 2016 AT THE MIDTOWN HILTON HOTEL

PROVISIONAL PROGRAMME VER 18A

TIP: PRINT DOUBLE SIDED, STAPLED ON TOP LONG EDGE

CLICK ON THE SESSION # FOR DETAILS OF THAT SESSION AS THEY BECOME AVAILABLE

TUESDAY 3 MAY – CMI PRECONFERENCE MEETINGS AND WELCOME RECEPTION		
CMI International Working Group and International Sub-Committee meetings at the Midtown Hilton		
Note: The CMI Bureau will be in the Gibson Room, 2 nd Floor, Hilton Hotel throughout the week		
0900 - 1630	CMI Executive Council meeting #1	Clinton Room, Hilton
0930 - 1630	CMI ISC	York Antwerp Rules and Guidelines on General Average
0930 - 1630	CMI IWGs	Other IWG meetings as required
1100 - 1130	Tea & Coffee break - CMI IWG/ISC attendees	
1300 - 1400	Lunch – CMI IWG/ISC attendees and EXCO	
1200 - 1800	Delegate Registration at the Hilton Check-in at the Hilton and other hotels	2nd Floor Promenade, Hilton Hotel
1730 - 1830	CMI Reception for National MLA Presidents	Beekman Room, Hilton
1830 - 2100	Welcome reception for all registered CMI delegates and accompanying persons, and MLAUS event ticketholders at the Hilton, including welcome	Trianon Ballroom, Hilton

	speeches from the Presidents of the CMI and MLAUS, and a keynote speaker. Entertainment, drinks and canapes to be provided		
WEDNESDAY 4 MAY			
0800 - 0845	CMI breakfast for judges attending the conference - Hosted by The Hon Judge Johanne Gauthier		Petit Trianon, Hilton
WEDNESDAY 4 MAY – CMI CONFERENCE RUNNING PARALLEL WITH CMI IWG AND MLAUS COMMITTEE MEETINGS			
0900 - 1030	<p style="text-align: center;">Sutton North & Centre, Hilton Opening Address: Rear Admiral Steven Poulin, JAG and Chief Counsel for the US Coast Guard **** COSTA CONCORDIA – Salvage & Wreck Removal Presentation by Capt Nick Sloane, Salvage Master of the <i>Costa Concordia</i> wreck removal operation off the Italian island of Giglio Chairs: John Hare, CMI Secretary-General and Jason R Harris, MLAUS Salvage Committee</p>		
1030 - 1100	Tea & Coffee – Promenade, 2nd Floor Hilton		
1100 - 1300	<p style="text-align: center;">Regent, Hilton</p> <div style="border: 1px solid black; padding: 5px; text-align: center; margin: 10px auto; width: 80%;"> Session 1 </div> <p>York Antwerp Rules and Guidelines on General Average Chair: Bent Nielsen Rapporteurs: Taco van der Valk and Richard Cornah, with Rodney Fonda</p>	<p style="text-align: center;">Sutton North & Centre, Hilton</p> <div style="border: 1px solid black; padding: 5px; text-align: center; margin: 10px auto; width: 80%;"> Session 2 </div> <p style="text-align: center;"><i>Panel discussion on the Costa Concordia operation and other issues</i> MLA Salvage Committee with MLA Cruise Lines and Passenger Ship Committee / MLA Maritime Torts and Casualty Committee Discussion panel: Stuart Hetherington, Jason R Harris, Charles G Deleo, Lawrence I Kiern, Katherine F Newman, Carol Finklehoffe and R Michael Underhill Speakers include: Lisa Reeves - The <i>El Faro</i> and Potential Limitation Implications Nick Platt - Lessons Learned: Casualty Responses from a Club's Perspective Judge Thomas A. Dickerson - Cruise Passengers Rights & Remedies 2016</p>	<p style="text-align: center;">Sutton South, Hilton</p> <div style="border: 1px solid black; padding: 5px; text-align: center; margin: 10px auto; width: 80%;"> Session 3 </div> <p>MLA Carriage of Goods by Sea Committee / CMI Rotterdam Rules IWG <i>A comparative analysis of how courts in different countries deal with Jurisdiction and Arbitration Clauses in Bills of Lading and Other Sea Carriage Documents</i> Chairs: Susan M Dorgan and Tomotaka Fujita Moderator: Michael Sturley Speakers: Ricardo Rozas (Chile) V.J. Matthew (India) Chester Hooper (US) Tomotaka Fujita (Japan)</p>
1300 - 1400	CMI & MLAUS Delegates networking lunch - Mercury & Rotunda, Hilton		

	Regent, Hilton	Sutton North & Centre, Hilton	Beekman, Hilton	Sutton South, Hilton
1400 - 1530	Cont/ ... General Average	<div style="border: 1px solid black; padding: 5px; text-align: center; color: blue; font-weight: bold;">Session 4</div> <p>CMI Offshore Activities IWG / MLA Offshore Industries Committee Chairs: Patrick Griggs and David R Walker</p>	<div style="border: 1px solid black; padding: 5px; text-align: center; color: blue; font-weight: bold;">Session 5</div> <p><i>The Liability of Classification Societies revisited –</i> CMI Liability of Classification Society IWG / with a representative from MLAUS IOSC Committee Chairs: Karl-Johan Gombrii and Robert G Clyne</p>	<div style="border: 1px solid black; padding: 5px; text-align: center; color: blue; font-weight: bold;">Session 6</div> <p><i>Maritime Security and the degree of comfort being offered by flag states and international conventions</i> CMI Ship Finance Security IWG / MLA Marine Financing Committee Chairs: Ann Fenech, and Marjorie F Krumholz Joint sitting with CMI Cross Border Insolvency IWG / Maritime Bankruptcy and Insolvency Committee <i>Continuing/...</i></p>
1530 - 1600	Tea & Coffee – Promenade, 2nd Floor Hilton			
	Regent, Hilton	Sutton North & Centre, Hilton	Beekman, Hilton	Sutton South, Hilton
1600 – 1700	Cont/ ... General Average	Cont/... CMI Offshore Activities IWG / MLA Offshore Industries Committee - <i>Discussion programme tba</i>	<div style="border: 1px solid black; padding: 5px; text-align: center; color: blue; font-weight: bold;">Session 8</div> <p><i>Towards a reformulation of principles of the Lex Maritima</i> CMI Lex Maritima IWG / Reps from MLAUS IOSC Committee Chair: Eric van Hooydonk</p>	Cont ... <div style="border: 1px solid black; padding: 5px; text-align: center; color: blue; font-weight: bold;">Session 7</div> <p>CMI Cross Border Insolvency IWG / Maritime Bankruptcy and Insolvency Committee Chairs: Chris Davis and John E Bradley <i>Recent cross-border trends and developments affecting shipping insolvencies, including the interplay of maritime and bankruptcy law, and the potential need for a protocol to the UNCITRAL Model Law addressing in rem actions.</i> Joint sitting with CMI Ship Finance Security IWG / MLA Marine Financing Committee</p>
1815	ROCK CENTRE EVENT -			
1830 – 2030	Meet in the foyer of the Hilton Hotel for short walk to Rockefeller Centre (transport on request)			
2030	Reception for registered CMI Conference delegates and accompanying persons, with MLAUS event ticketholders, in the Rock Centre Café courtyard, with visit to the Top of the Rock observation deck			
	Walk back to Hilton Hotel (transport on request)			

THURSDAY 5 MAY – CMI GENERAL AVERAGE CONFERENCE
RUNNING PARALLEL WITH CMI IWG AND MLAUS COMMITTEE MEETINGS

0800 - 0845	<i>Whither the CMI? – the debate continues -</i> MLAUS breakfast for NMLA Presidents in attendance - Hosted by The President, MLAUS Hilton Hotel venue tba			
	Regent, Hilton	Sutton North/Centre Hilton	Madison, Hilton	Sutton South, Hilton
0900 - 1030	<i>Cont/ ...</i> General Average	<div style="border: 1px solid black; text-align: center; margin: 0 auto; width: 100px; padding: 2px;">Session 9</div> <p>CMI Cybercrime in Shipping IWG / MLA Cybersecurity Committee / MLA Website and Technology Committee Chairs: Joseph A Walsh, Nash Bilisoly, Blythe Daly and Robert Hoepel</p> <p><i>Cont after teabreak/...</i></p>	<div style="border: 1px solid black; text-align: center; margin: 0 auto; width: 100px; padding: 2px;">Session 11</div> <p><i>Maritime arbitration awards, the New York Convention, and the enforcement of awards in various jurisdictions</i> CMI Arbitration IWG / MLA Arbitration and ADR Committee Chairs: Luc Grellet and Leo G Kailas</p>	<div style="border: 1px solid black; text-align: center; margin: 0 auto; width: 100px; padding: 2px;">Session 12</div> <p><i>Current issues of Polar Shipping Law -</i> CMI Polar Shipping IWG / MLA International Organisations, Conventions, and Standards Committee (IOSC) Chairs: Aldo Chircop and Phillip A Buhler</p>
1030 - 1100	Tea & Coffee – Promenade, 2nd Floor Hilton			
	Regent, Hilton	Sutton North/Centre, Hilton	Beekman, Hilton	Madison, Hilton
1100 – 1200	<i>Cont/ ...</i> General Average	<div style="border: 1px solid black; text-align: center; margin: 0 auto; width: 100px; padding: 2px;">Session 10</div> <p>Cybercrime in Shipping: Case study on the Port of Antwerp Hackers</p>	<div style="border: 1px solid black; text-align: center; margin: 0 auto; width: 100px; padding: 2px;">Session 13</div> <p><i>What is a Ship?</i> CMI Ship Nomenclature IWG Chair: Frank Nolan</p>	<div style="border: 1px solid black; text-align: center; margin: 0 auto; width: 100px; padding: 2px;">Session 14</div> <p><i>Liability for Wrongful Arrest</i> CMI Arrest IWG/ MLA Practice and Procedure Committee Chairs: Giorgio Berlingieri and Gina M Venezia</p>

1200 - 1300		Session 15	Session 16	Session 17	Cont/... CMI Polar Shipping IWG / MLA IOSC
		<i>Piracy update</i> CMI Acts of Piracy and Maritime Violence IWG / MLAUS Maritime Criminal Law Committee Chair: Andrew Taylor	<i>Legal issues of unmanned craft</i> CMI Unmanned craft IWG / MLA Regulation of Vessel Operations, Safety, Security and Navigation Committee Chairs: Tom Birch Reynardson, Lawrence I Kiern	<i>Judicial Sales Update</i> CMI Judicial Sales IWG / MLA Practice and Procedure Committee Chairs: Henry Hai Li and Gina M Venezia	
1300 - 1400	CMI & MLAUS Delegates networking lunch – Mercury & Rotunda, Hilton MLAUS Board and CMI EXCO lunch at NY Yacht Club				
	Regent, Hilton	Sutton North/Centre, Hilton			Sutton South, Hilton
1400 - 1530	Cont/ ... General Average	Session 18			Cont/... CMI Polar Shipping IWG / MLA IOSC
		<i>Recent reforms of domestic maritime laws and EU Shipping Law update</i> CMI recurring topic, presented by a selection of NMLA members <i>Vincent Power, CMI Rapporteur on EU Shipping Law, plus five invited speakers (one from USA), with interventions from the floor and discussion</i> Chairs: John Hare and Kevin G O'Donovan			
1530 - 1600	Tea & Coffee – Promenade, 2nd Floor Hilton				
	Regent, Hilton	Sutton North/Centre, Hilton	Beekman, Hilton		Sutton South, Hilton
1600 - 1700	Cont/ ... General Average	Session 19	Session 20	Session 21	Cont/... CMI Polar Shipping IWG / MLA IOSC
		CMI Marine Insurance IWG / MLA Marine Insurance and General Average Committee Chairs: Joseph Grasso and Andrew C Wilson	<i>Current pressing maritime problems - Legal issues relating to Refugee MiGgration at Sea</i> - John Hare CMI Refugee Migration at Sea Committee / MLA Regulation of Vessel Operations, Safety, Security and Navigation Committee / MLA IOSC	<i>Shipping law issues relating to pandemic response at sea – Bud Darr</i> (Cruise Lines International Association) with Natalie Shaw (International Chamber of Shipping) Chairs: Olivia Murray, CMI Fair Treatment of Seafarers in the event of a Maritime Accident IWG / Lawrence I. Kiern MLAUS Regulation of Vessel	

			Operations, Safety, Security and Navigation Committee	
1800 - 1930	NICHOLAS HEALY MEMORIAL LECTURE	New York University, Downtown Campus 40 Washington Square Park South (entrance on W 4th St) Admission to all (event ticket reservation required) Snacks and drinks will kindly be provided by NYU Guides and transport to and from NYU will be available		
FRIDAY 6 MAY - MLAUS ANNUAL GENERAL MEETING AND CMI PLENARY AND ASSEMBLY Y CMI AND Y MLAUS CLE PROGRAMME				
0930 - 1200	MLAUS Annual General Meeting - attendance open to all Guides will be on standby to accompany delegates from the Hilton to the AGM and return			
1230 -1330	CMI & MLAUS Delegates light lunch - Hilton			
	Trianon Ballroom, Hilton	Sutton North & Centre, Hilton		
1330 - 1430	CMI Plenary	<div style="border: 1px solid black; padding: 5px; display: inline-block;">Session 22</div> Young CMI / Young MLAUS CLE programme Chairs: K Blythe Daly and Robert Hoepel		
1430 - 1500	Tea & Coffee – Promenade, 2nd Floor Hilton			
	Trianon Ballroom, Hilton	Sutton South & Regent, Hilton	Sutton North & Centre, Hilton	
1500 - 1700	CMI Assembly Formal attendance by up to three nominated representatives of CMI member associations. Informal attendance open to all	cont/ Young CMI / Young MLAUS programme	cont/ MLA CLE Programme presentations	
1715 - 1745	CMI EXCO meeting #2		Clinton, Hilton	
1800 – 1930 1930 - 2200	Predinner cocktails Combined gala dinner of the CMI and the MLAUS With a surprise gig by the Seven Seas Band – of maritime lawyers!	Petit Trianon, Hilton Hotel Trianon Ballroom, Hilton Hotel		

The following MLAUS Committees have not been accommodated. These committees have no parallel in the CMI IWGs. They may be allocated venues at the Hilton, or be held elsewhere.

The Madison Room of the Hilton is available all day Wednesday should it be needed. Capacity 100 pax theatre, 60 classroom

- In-house Counsel Committee
- Recreational Boating Committee
- Committee on Proctor Admissions
- Inland Waters and Towing Committee
- Fisheries Committee
- Stevedores Marine Terminals and Vessel Services Committee
- Committee Chairs

- Planning Committees

HILTON NEW YORK - SECOND FLOOR

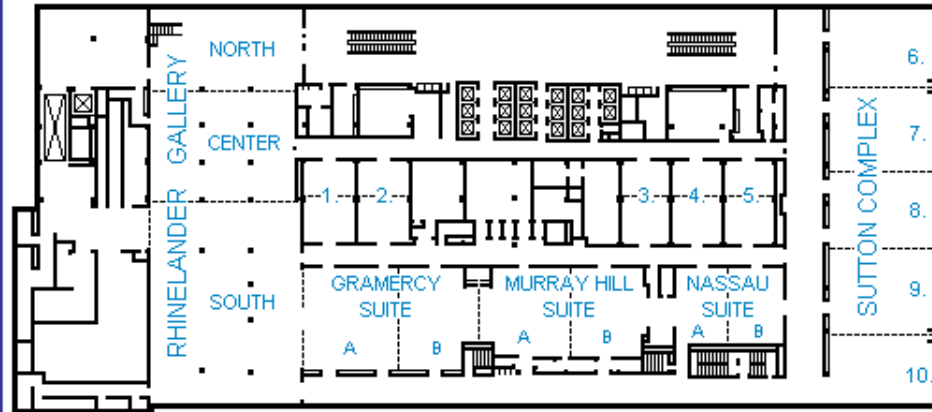

- | | |
|------------------|-------------------|
| 1. BRYANT SUITE | 6. BEEKMAN PARLOR |
| 2. MORGAN SUITE | 7. SUTTON NORTH |
| 3. MADISON SUITE | 8. SUTTON CENTER |
| 4. CLINTON SUITE | 9. SUTTON SOUTH |
| 5. GIBSON SUITE | 10. REGENT PARLOR |

HILTON NEW YORK - THIRD FLOOR

